

# MT. SAN ANTONIO COLLEGE

## 2018 Educational and Facilities Master Plan Update

JANUARY 22, 2018 // COMMUNITY FACILITIES PLAN ADVISORY COMMITTEE MEETING

# Agenda

- / DISCUSSION ON INTRODUCTION AND CHAPTERS 7, 8 + 9
- / DOCUMENT REVIEW SCHEDULE
- / CAMPUS PEDESTRIAN CIRCULATION
- / NEIGHBORHOOD ORGANIZATION CONCEPT
- / NEXT STEPS

# Discussion on Introduction and Chapters 7, 8 + 9

# INTRODUCTION

/ Acknowledgments

/ Letter from the President and CEO

/ Letter from the Board of Trustees

/ Table of Contents

/ Executive Summary

/ Mission, Vision, and Core Values

/ Purpose

/ Process and Participation

/ Document Overview



# CHAPTER 7: *EXISTING FACILITIES CONDITIONS ANALYSIS*

/ Overview

/ Community Context

/ Campus and Facilities

/ Transportation and Circulation

/ Open Space and Landscape

/ Farm Analysis

/ Mt. SAC Hangar at Brackett Field



# CHAPTER 8: *EXISTING ENVIRONMENTAL ANALYSIS*

/ Overview

/ Campus Sustainability

/ Campus Climate Conditions

/ Resource Management

/ Carbon Footprint Analysis



# CHAPTER 9: *FRAMEWORK FOR FACILITIES RECOMMENDATIONS*

/ Overview

/ Implications of the Master Plan Themes

/ Student Feedback

/ Community Feedback

/ Projection of Space Needs

/ Sustainability Objectives

/ Best Facilities Planning Practices



# Updates

SEPTEMBER  
2016

APRIL  
2018  
BOARD  
APPROVAL

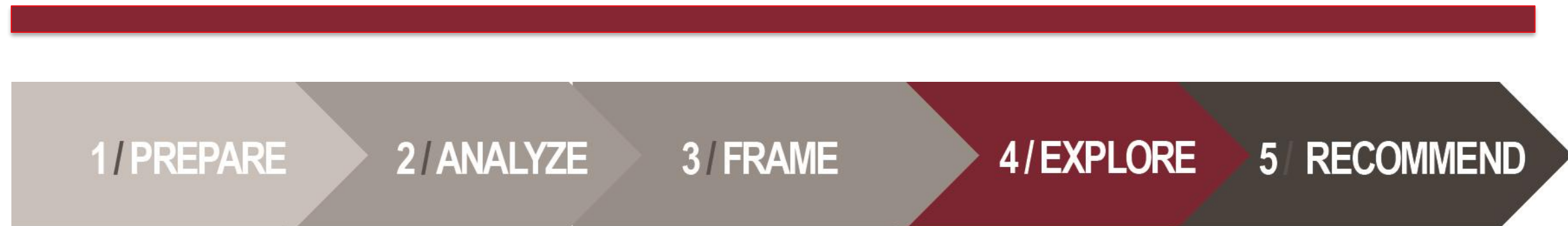

JANUARY  
2018



# DOCUMENT REVIEW SCHEDULE

REVIEWERS	CHAPTERS													Appendix					
	Intro	1	2	3	4	5	6	7	8	9	10	11	12						
<b>CMPCT</b>	Tue 11/21	<b>COMPLETED</b>						Tue 11/21	Tue 11/21	Tue 12/05	Mon 1/22	Mon 1/22	Mon 1/22		Distribute				
	Fri 12/01							Fri 12/01	Fri 12/01	Fri 12/08	Fri 2/02	Fri 2/02	Fri 2/02		Comments Due				
<b>MPSTF</b>	Tue 11/21							Tue 11/21	Tue 11/21	Fri 12/08	Mon 1/22	Mon 1/22	Mon 1/22		Distribute				
	Fri 12/01							Fri 12/01	Fri 12/01	Wed 1/03	Fri 2/02	Fri 2/02	Fri 2/02		Comments Due				
<b>FAC</b>	-							-	-	-	Mon 1/22	Mon 1/22	Mon 1/22		Distribute				
	-							-	-	-	Fri 2/02	Fri 2/02	Fri 2/02		Comments Due				
<b>College-wide + CFPAC (initial review)</b>	Fri 12/08							Fri 12/08	Fri 12/08	Fri 12/08	<b>WINTER BREAK</b>				Distribute				
	Wed 1/03							Wed 1/03	Wed 1/03	Wed 1/03	<b>WINTER BREAK</b>				Comments Due				
Tri-Chair Comment Review	Thursday, December 14th												11:00am - 01:00pm						
Tri-Chair Comment Review	Wednesday, January 10th												01:00pm - 03:00pm						
<b>Board of Trustees (overview)</b>	Monday, January 22, 2018												Distribute						
	Saturday, February 3, 2018 Special Board Meeting												Comments Due						
Tri-Chair Comment Review	Monday, February 5, 2018												10:00am - noon						
Presentation to Faculty + Staff (262/651)	Friday, February 23, 2018 (Flex Day Breakout Session) "Getting to Know the Mt. SAC 2018 Educational and Facilities Master Plan (EFMP)"												10:45am - noon DTC Room 13-1700						
<b>College-wide + CFPAC (final review)</b>	Monday, February 19, 2018												Distribute						
	Tuesday, March 13, 2018												Comments Due						
Student Public Forum	Wednesday, March 14, 2018												1:00pm - 2:00pm DTC Room 13-1700						
<b>Board of Trustees (first read)</b>	Monday, February 19, 2018												Distribute						
	Wednesday, March 14, 2018 Board Meeting												Comments Due						
Tri-Chair Comment Review	Monday, March 19, 2018												10:00am - noon						
<b>Board of Trustees Final Approval</b>	Monday, April 2, 2018												Distribute						
	Wednesday, April 11, 2018 Board Meeting												Comments Due						



**CMPCT**  
**MPSTF**  
**CFPAC**  
**FAC**

Campus Master Plan Coordinating Team  
Master Plan Steering Task Force  
Community Facilities Plan Advisory Committee  
Facilities Advisory Committee

# Campus Pedestrian Circulation

# OPEN SPACE CONCEPT

## LEGEND

- PROPERTY LINE-----
- FACILITIES
- PRIMARY PEDESTRIAN CIRCULATION
- SECONDARY PEDESTRIAN CIRCULATION
- TERTIARY PEDESTRIAN CIRCULATION
- HEALTHY LIVING LOOP
- TEMPLE AVENUE GREEN CORRIDOR
- OPEN SPACE
- GREEN GATEWAYS



# OPEN SPACE CONCEPT

## LEGEND

- PROPERTY LINE -----
- FACILITIES**
- FACILITIES UNDER CONSTRUCTION -----
- LANDSCAPE UNDER CONSTRUCTION -----
- PRIMARY PEDESTRIAN CIRCULATION -----
- SECONDARY PEDESTRIAN CIRCULATION -----
- TERTIARY PEDESTRIAN CIRCULATION -----
- MULTI-PURPOSE TRAIL -----
- HEALTHY LIVING LOOP -----
-  TRANSIT STOPS
-  CAMPUS SHUTTLE STOPS
-  FUTURE TRANSIT CENTER
- CROSSWALKS -----
-  PASSENGER DROP-OFF/PICK-UP (DESIGNATED)
- PEDESTRIAN TUNNEL -----
- PEDESTRIAN BRIDGE -----

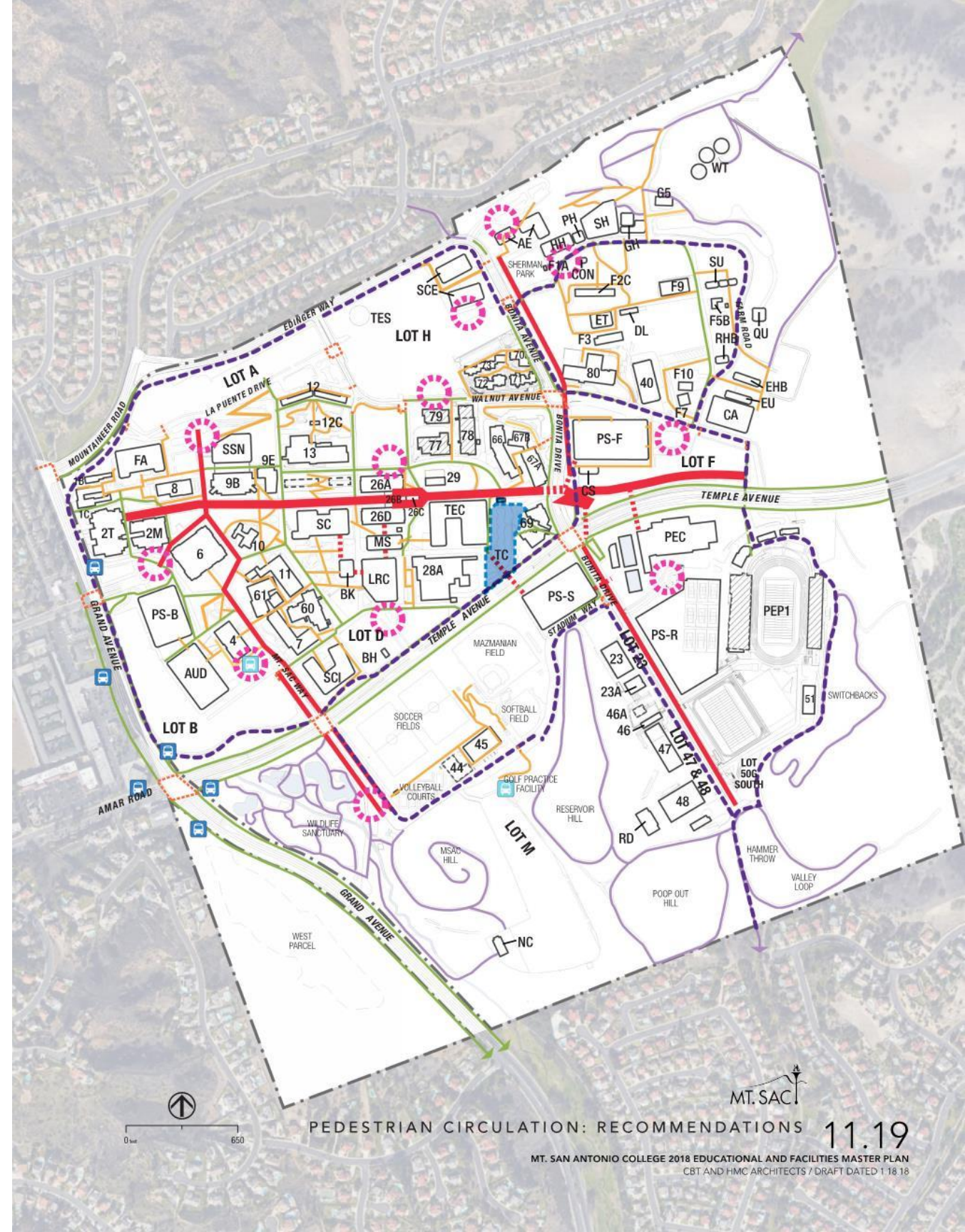

# PEDESTRIAN CIRCULATION HIERARCHY

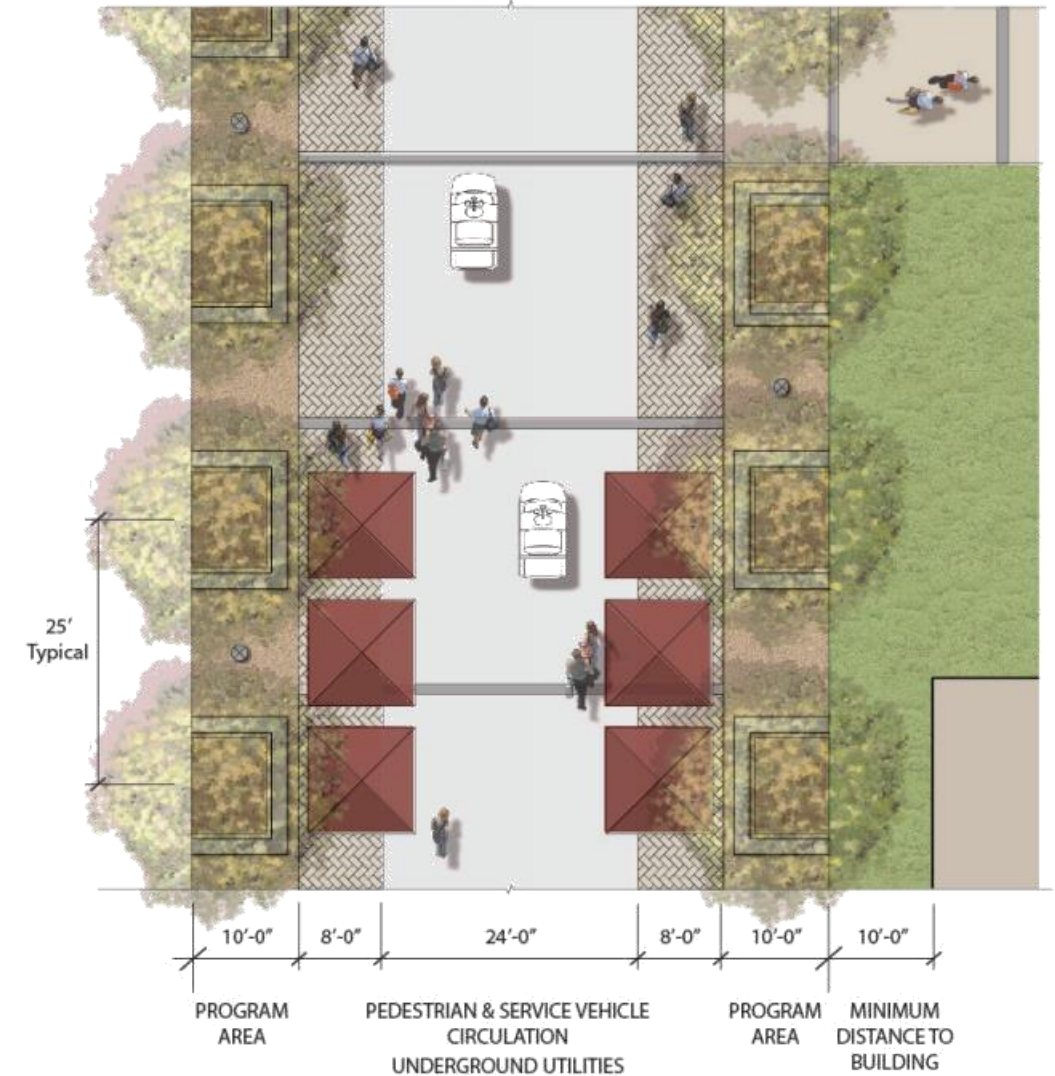
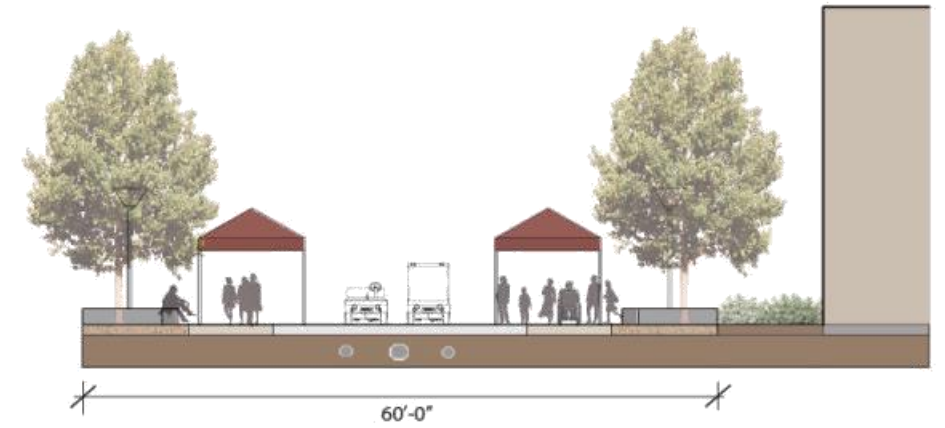
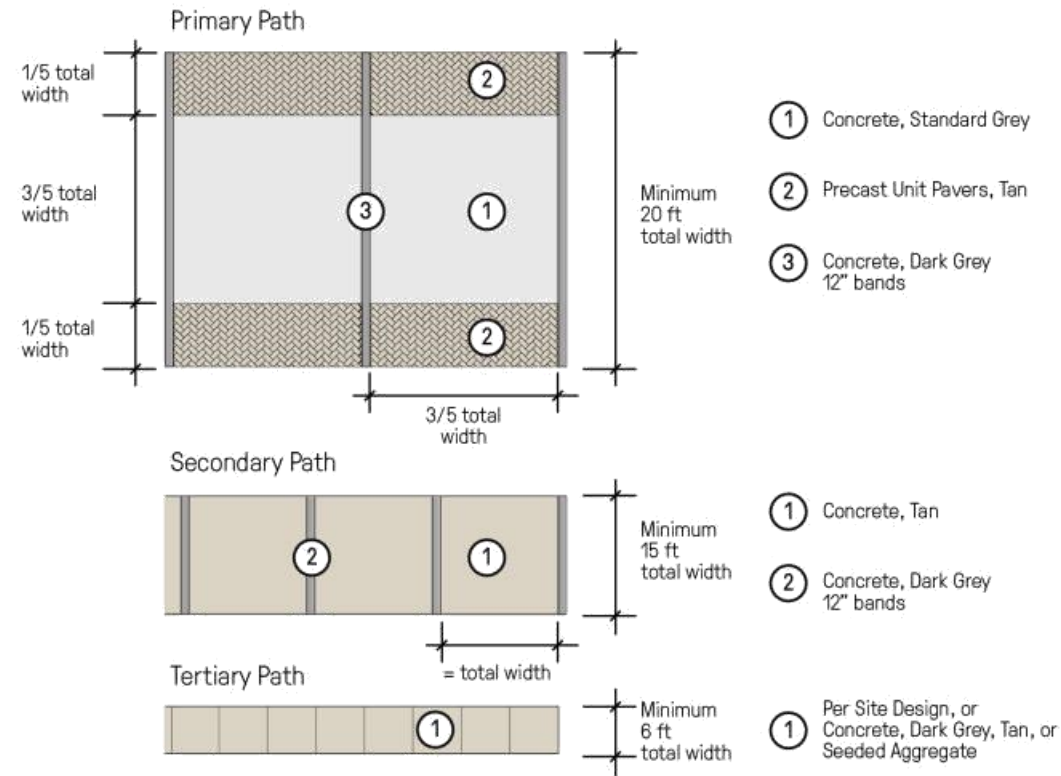

Image of similar spaces at other colleges:



# Campus Neighborhoods

# RECOMMENDED LAND USE

- / Primary Educational Zone
- / Athletics Zone
- / Agricultural Zone
- / Wildlife Sanctuary / Open Space Zone
- / Land Management Zone
- / Solar Zone

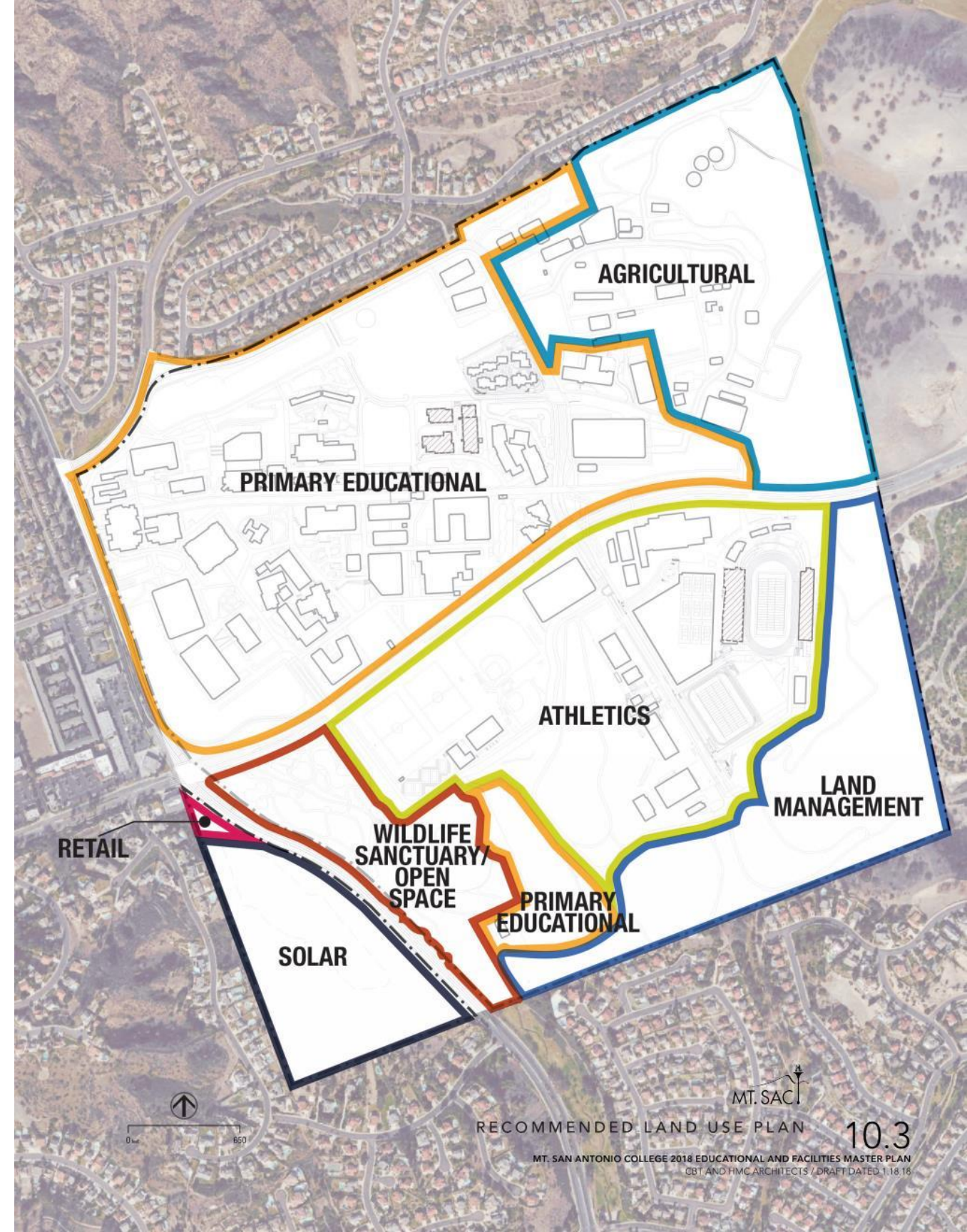

# NEIGHBORHOOD ORGANIZATION: FIRST PASS

/ Renumber all buildings: 3-digit system

/ Organize neighborhoods by function

## LEGEND

010s	CAMPUS SUPPORT
100s	WEST
200s	ART
300s	STUDENT SERVICES
400s	SCIENCE
500s	CENTRAL
600s	EAST
700s	NORTH
800s	FARM
900s	SOUTH

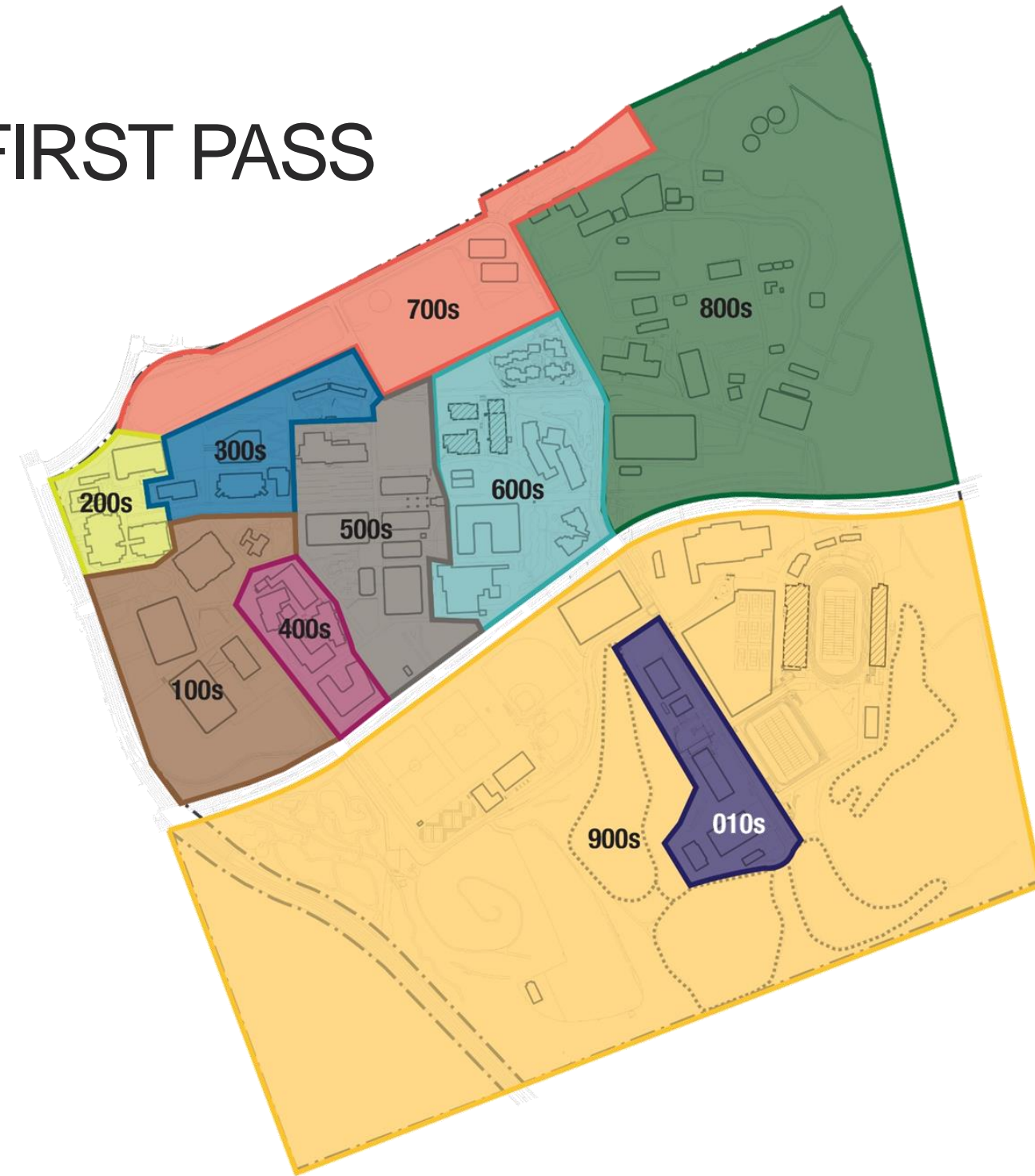



# NEIGHBORHOOD CONCEPT

- / Use Grand Avenue, Temple Avenue, and Miracle Mile as primary organizing elements
- / Link neighborhoods to physical elements for easy wayfinding
- / Use major roads and pedestrian paths to define neighborhoods

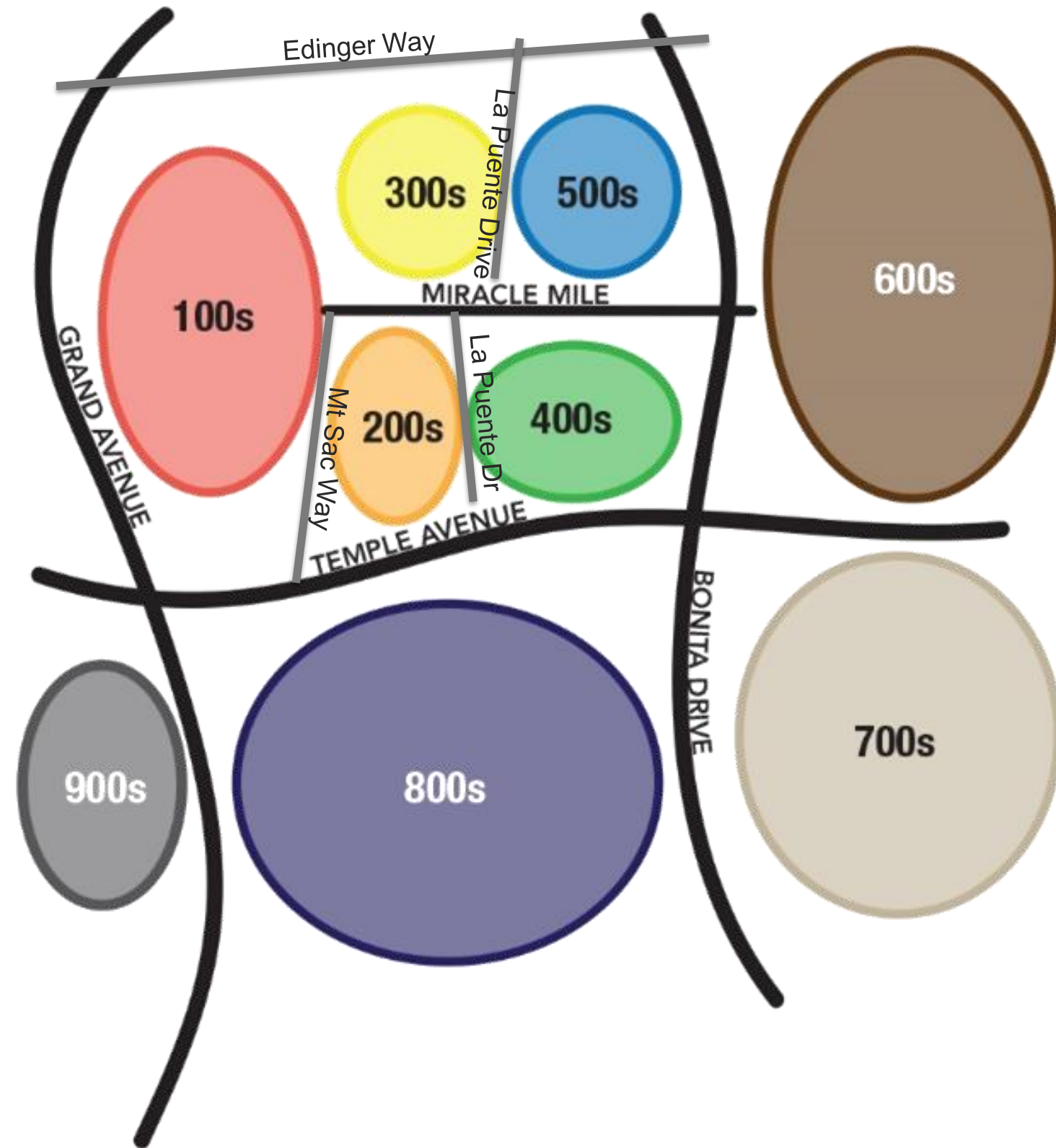

# PROPOSED NEIGHBORHOODS

/ 100s

/ 200s

/ 300s

/ 400s

/ 500s

/ 600s

/ 700s

/ 800s

/ 900s

(The Farm)

(West Parcel)



# Next Steps

- / Ongoing review of draft chapters
- / Special Board Meeting (February 3<sup>rd</sup>, 2018)
- / Board of Trustees document approval (Spring 2018)